



AmbiStar

AMBISTAR ELE BALLAST (2) 26W CFL (4-PIN) 120V

Ambistar electronic ballasts are an easy-to-install, energy-efficient replacement solution for optimizing residential and hospitality lighting.

Product data

General Information	
Lamp Type	CFQ26W/G24Q
Number of Lamps	1/2 piece/unit
Ballast Type	Electronic Fluorescent
Base Model	RCF2S26H1LDQS
Suitable For Outdoor Use	Yes
Automatic Restart	Yes

Operating and Electrical	
Input Voltage	120 V
Input Frequency	60 Hz
Max THD	10 %
Power (Rated) (Nom)	26 W
Starting Method	Rapid Start
Lamp Current Crest Factor (Nom)	1.7
Ignition Time (Nom)	1 s
Ballast Factor (Nom)	1
Power Factor (Nom)	0.98
Input Current (Operating) (Nom)	0.43 A
Input Power (Nom)	51 W
Rated Lamp Watts	26W W

Wiring	
Color Input Terminals	BLK & WHT

Color Output Terminals	RED, YEL & BLU
Wire Striplength	0.375 mm
Lamp Connection	Series
Wire Length By Color	No wires
Wire Gauge (Nom)	18AWG mm
Wire Type	Solid
Remote Wiring Configuration Allowed	Yes
Tandem Wiring Configuration Allowed	Yes
Through Wiring Configuration Allowed	Yes
Max Ballast-Lamp Distance Remote Wiring	1-L = 15' / 2-L = 6'
Max Ballast-Lamp Distance Tandem Wiring	2-L: Red = 6'
Max Ballast-Lamp Distance Through Wiring	2-L: Red = 6'
Connector Type	Poke-In

Temperature	
T-Case Maximum (Nom)	85 °C

Mechanical and Housing	
Housing Material	Metal/Plastic
Housing	H1
Housing Dimensions	4.98" x 2.4" x 0.98"

Approval and Application	
EMC Immunity Standard	FCC Consumer

Sound Rating	A
UL Recognized	No
Product Data	
Order product name	AMBISTAR RCF2S26H1LDQS35M
EAN/UPC - Product	781087027455
Order code	RCF2S26H1LDQS35M

Numerator - Quantity Per Pack	1
Numerator - Packs per outer box	20
Material Nr. (12NC)	913710214702
Net Weight (Piece)	159.000 g

Dimensional drawing

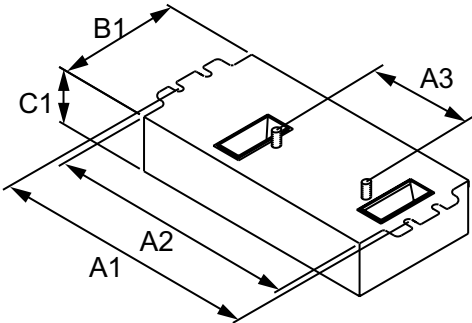

Product	A1	A2	A3	B1	C1
---------	----	----	----	----	----

ELE BALLAST (2) 26W CFL (4-PIN) 120V

