



TRAC-LITES STEP CYLINDERS SERIES R510, R511 and R512

Project: _____

Fixture Type: _____

Location: _____

Contact/Phone: _____

PRODUCT DESCRIPTION

Construction Drawn steel housing with polycarbonate stem.

Lampholder Medium base porcelain socket with nickel plated copper screw shell.

Aiming 90° vertical aiming capability and 358° rotation.

Adapter Copper alloy contacts provide precise spring action • True, positive electrical ground • On/off switch included • Patented embossed polarity arrows on bottom of adapter • Spring-loaded locking latch with embossed polarity arrows secures track light to track • Compatible with both Trac-Lites and Trac-Master track • "Pull-up" contact to up position for use on Trac-Master two-circuit track.

Labels UL/CUL listed.

Specifications subject to change without notice.

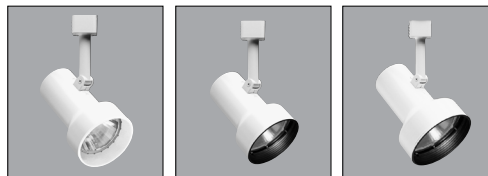

Line Voltage R20/PAR20

Catalog Number	Baffle	Finish	Lamp
R510 BL	None	Black	50W R20/PAR20

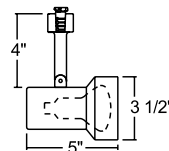

Line Voltage R20/PAR20

Catalog Number	Baffle	Finish	Lamp
R511 BLB BL	Black	Black	50W R20/PAR20
R511 WHB WH	White	White	50W R20/PAR20

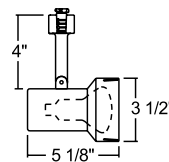

Line Voltage BR30/PAR30L

Catalog Number	Baffle	Finish	Lamp
R512 BLB WH	Black	White	65W BR30/75W PAR30L
R512 BLB BL	Black	Black	65W BR30/75W PAR30L
R512 WHB WH	White	White	65W BR30/75W PAR30L

