

PL1/O-6 SHOWN

PART NUMBER	NO. OF PORTS	LENGTH
PL1/O-2	2	1.35
PL1/O-3	3	2.00
PL1/O-4	4	2.65
PL1/O-5	5	3.30
PL1/O-6	6	3.95
PL1/O-8	8	5.25
PL1/O-10	10	6.55
PL1/O-12	12	7.85
PL1/O-14	14	9.15

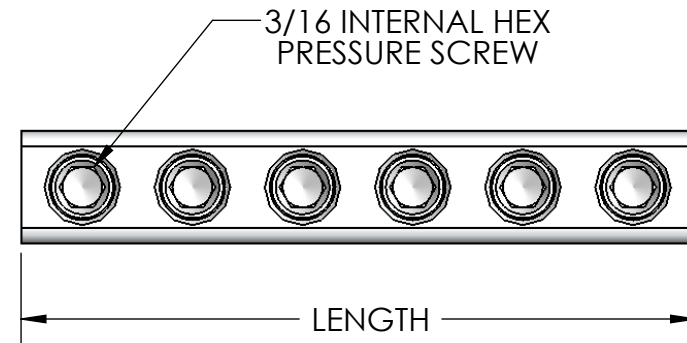
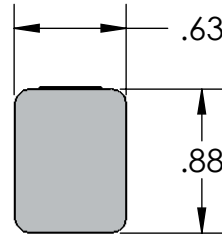

3/16 INTERNAL HEX
PRESSURE SCREW

LENGTH

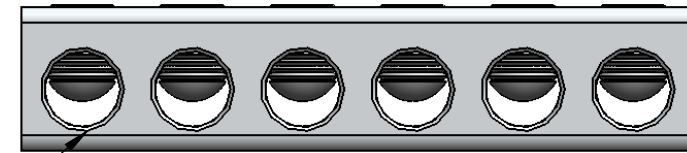

WIRE ENTRY PORT
WIRE RANGE: 1/0 - #14 AWG
PRE-FILLED W/ OXIDE INHIBITOR

CONTACT NSI FOR SALES @ 800.321.5847

NOTES:

1. CONNECTOR MANUFACTURED FROM 6061-T6 ALUMINUM ALLOY.
2. CONNECTOR CHROMATED FOR INCREASED CORROSION RESISTANCE.
3. UL LISTED PER UL486A/B SPECIFICATIONS FOR 600V.
4. DUAL RATED FOR 90°C COPPER AND/OR ALUMINUM CONDUCTOR.

		POLARIS SALES CO. INC	
		11625 PROSPEROUS DRIVE ODESSA, FL 33556	
PROPRIETARY AND CONFIDENTIAL		TITLE: UNINSULATED 1/0 CONNECTOR	
THE INFORMATION CONTAINED IN THIS DRAWING IS THE SOLE PROPERTY OF POLARIS SALES CO. INC. ANY REPRODUCTION IN PART OR AS A WHOLE WITHOUT THE WRITTEN PERMISSION OF POLARIS SALES CO. INC. IS PROHIBITED.		DWG. NO. PL1,0-	
DRAWN BY S.PARRY	NAME S.PARRY	DATE 07/2012	MATERIAL: N/A
SCALE: N/A		SHEET: 1 OF 1	