

# GRTS Conduit Outlet Boxes

## Explosionproof, Dust-Ignitionproof

UNILETS™ for use with Threaded Metal Conduit. Furnished with Internal Ground Screw and O-ring.

### NEC/CEC:

Class I, Division 1 and 2, Groups B ♦, C, D  
Class II, Division 1 and 2, Groups E, F, G  
Class III  
Class 1, Zone 1 and 2, IIA, IIB, IIB + H2 ♦

### NEC/CEC:

NEMA 3, 4, 4X ①  
IP66 (without drain)

### Applications

- Ideally suited for stanchion mounted lighting.
- For pulling of wires.
- Connect conduit lengths and change direction of conduit runs.
- Provide access for maintenance.

### Features

- T-configurations with large center 1-1/2" hub for direct stanchion pole mounting.
- Side hub entry options: 1-1/2" to cover most needs or 3/4" for most common conduit attachment.
- Unique mounting feet to provide extra support or when used with cable.
- Captive cover with aviation cable eliminates drop hazard.
- Standard O-rings provide raintight fit. NEMA 3, 4.
- Ambient temperature range:
  - Without drain -40 °C to +60 °C (-40 °F to +170 °F).
  - With drain -25 °C to +40 °C (-13 °F to 104 °F).

### Standard Materials

- Body: ductile iron or copperfree (4/10 of 1% max.) aluminum
- Cover: copperfree (4/10 of 1% max.) aluminum

### Standard Finishes

- Ductile iron bodies: triple-coat — (1) zinc electroplate, (2) chromate, and (3) epoxy powder coat
- Aluminum bodies and covers: epoxy powder coat

### Options

(see Numbering Guide for suffixes)

- Drain
- DIN Rail mounted terminal blocks

### NEC/CEC Certifications and Compliances

- UL Standard: UL 1203
- CSA Standard: C22.2 No. 25, C22.2 No. 30
- cULus Listed: E85310

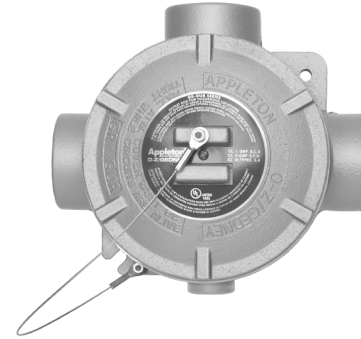

GRTS150 Box

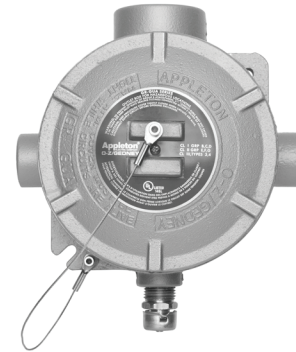

GRTS15075 Box

							Catalog Number	
GRTS Series		Hub Size LEFT (Inches)	Hub Size CENTER (Inches)	Hub Size RIGHT (Inches)	Cover Opening mm (in)	Volume Capacity dm <sup>3</sup> (in <sup>3</sup> )	Ductile Iron Body with Aluminum Cover	Aluminum Body with Aluminum Cover
  <b>150</b>	 <b>15075</b>	1-1/2	1-1/2	1-1/2	123.95 (4.88)	1.18 (72.0)	<b>GRTS150</b>	<b>GRTS150-A</b>
		3/4	1-1/2	3/4	123.95 (4.88)	1.18 (72.0)	<b>GRTS15075</b>	<b>GRTS15075-A</b>

### Catalog Numbering Guide — GRTS Options (Example Item: GRTS15075ADT12)

GRTS	15075	A	D	T12
Series Prefix: <b>GRTS</b> - T Style Stanchion Mount	Hub Configuration: <b>150</b> - 1-1/2" (Left, Center, Right) <b>15075</b> - 3/4" (Left), 1-1/2" (Center), 3/4" (Right)	Material: <b>Blank</b> - Iron <b>A</b> - Aluminum	Drain: <b>Blank</b> - No drain <b>D</b> - Drain	Terminal Block: <b>Blank</b> - No terminal block <b>T6</b> - 6 Position <b>T12</b> - 12 Position

♦ In Class I, Division 1, Group B atmospheres, all conduit runs must have a sealing fitting (not supplied) field-installed adjacent to the enclosure.

① Aluminum body and cover only.

# GRTS Conduit Outlet Boxes

## Explosionproof, Dust-Ignitionproof

UNILETS™ for use with Threaded Metal Conduit. Furnished with Internal Ground Screw and O-ring.

### NEC/CEC:

Class I, Division 1 and 2, Groups B♦, C, D  
Class II, Division 1 and 2, Groups E, F, G  
Class III  
Class 1, Zone 1 and 2, IIA, IIB, IIB + H2♦

### NEC/CEC:

NEMA 3, 4, 4X ①  
IP66 (without drain)

### Replacement Parts

### Catalog Number

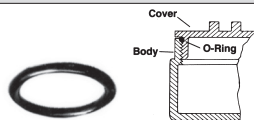

#### O-ring—Buna-N

Provides raintight fit

GRG-3



#### Drain

1/2" trade size

ECD50B4X



#### Terminal Block—DIN Rail Mounted ②

For use in GRTS boxes. Wire range of #26-#10 AWG. Mounts on two pre-drilled/tapped holes.

6 Position

TBDIN06

12 Position

TBDIN12

### Dimensions in Millimeters (Inches)

Dimensions in Millimeters (Inches)									
	A	B	C	D	E	F	G	H	I
GRTS Series									
150	146.1 (5.75)	93.7 (3.69)	128.7 (5.07)	28.0 (1.10)	93.2 (3.67)	35.1 (1.38)	181.5 (7.14)	7.9 (0.31)	170.6 (6.72)
15075	146.1 (5.75)	93.7 (3.69)	128.7 (5.07)	28.0 (1.10)	93.2 (3.67)	35.1 (1.38)	181.5 (7.14)	7.9 (0.31)	170.6 (6.72)
J				K					
Hub Size (Inches)	1-1/2"	3/4"	1-1/2"	3/4"					
GRTS Series									
150	35.1 (1.38)	-	24.2 (0.95)	-					
15075	35.1 (1.38)	20.6 (0.81)	24.2 (0.95)	21.6 (0.85)					

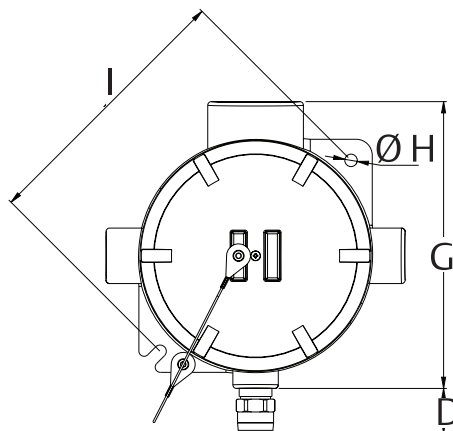
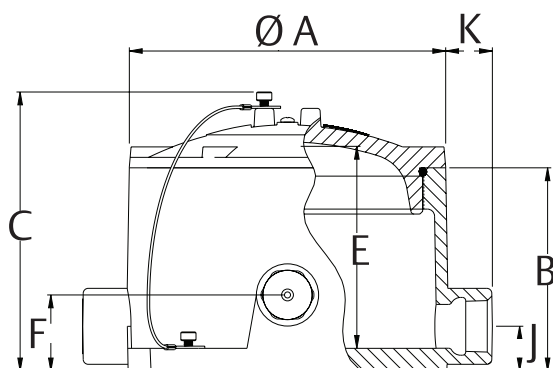

♦ In Class I, Division 1, Group B atmospheres, all conduit runs must have a sealing fitting (not supplied) field-installed adjacent to the enclosure.

① Aluminum body and cover only.

② Terminal block is UL listed and CSA certified for 600 Volt, 30 Amp.