

IEC Pin and Sleeve

20A, 125/250V, 3 Pole, 4 Wire

Watertight Receptacle

Features

- Corrosion-resistant self-closing gasketed cover
- Sequential contact engagement to prevent a momentary over-voltage on components
- Super tough insulated non metallic house for impact and chemical resistance
- Color coded housings for easy identification
- Multi contact spring provides and maintains high unit pressure on mating pins to minimize temperature rise

Ordering Information

| Description | UPC | Catalog Number |
|--|--------------|----------------|
| Watertight IEC Pin and Sleeve Receptacle | 783585404400 | HBL420R12W |

Device Color
Orange

Standards

UL Listed, File E146032
CSA Standard C22.2 No. 182.1
UL Classified to IEC 60309-1 IEC 60309-2

Specifications

| | |
|-----------------|------------------------------------|
| Housing | Zytel® 101 Nylon |
| Mounting Flange | Zytel® 101 Nylon |
| Cover | Reinforced Thermoplastic Polyester |
| Gaskets | Solid Neoprene |
| Cover Screw | Nickel-plated brass |

Performance

| Electrical | |
|----------------------|--|
| Current Interrupting | Certified for current interrupting at full rated current |
| Dielectric Voltage | 3000V AC |
| Max. Working Voltage | 600V RMS |
| Temperature Rise | Max. 30°C temperature rise at full rated current after 50 cycles of overload at 150% of rated current at a power factor of 75% |

Mechanical

| | |
|-------------------------|--|
| Impact Resistance | Per CSA C22.2 No.182.1 /UL1682 |
| Product Identification | Identification and ratings are a permanent part of the device housing |
| Terminal Identification | Terminals identified in accordance with North American and IEC conventions |

Environmental

| | |
|------------------------|--|
| Flammability | HB or better per UL 94 or CSA C22.2 No. 0.17 |
| Ingress Protection | IP67 Suitability |
| Moisture Resistance | Watertight per IEC 60309-1 |
| Operating Temperatures | Maximum Continuous 75°C; Minimum - 40°C w/o impact |

Accessories

- Back Boxes
- Cover Assemblies

Online Resources

- Customer Use Drawing
- eCatalog
- Installation Instructions

Dimensions in Inches (mm)

Hubbell Wiring Device-Kellems • Hubbell Incorporated (Delaware) • 40 Waterview Drive • Shelton, CT 06484

Phone (800) 288-6000 • Fax (800) 255-1031 • Specifications subject to change without notice.

HUBBELL

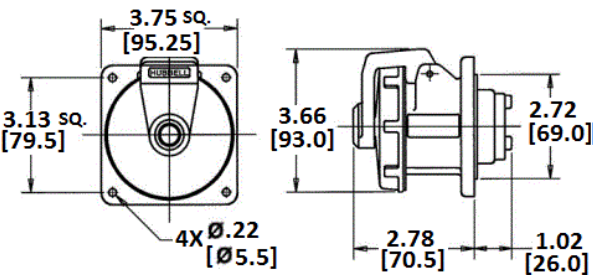

Wiring Device-Kellems