

# Pan-Way® T-70 Surface Raceway System

## specifications

T-70 non-metallic multi-channel capable surface raceway shall be used to route, protect, and conceal data, voice, video, fiber optic and power cabling. The raceway shall be listed as suitable for use in applications up to 600 volts between conductors by Underwriters Laboratories, Inc. per standard 5A, and by Canadian Standards Association, Inc. per 22.2 no. 62.1-03, when screw secured and installed per instructions. A full complement of fittings with a 1" minimum bend radius compliant with TIA/EIA-568-B, must be available as well as device brackets and internal junction boxes to install a variety of communication and electrical devices. Divider walls must be available to form separate channels in the multi-channel raceway. Snap-on faceplates for data and power terminations shall be available. An offset box shall be available, with versions for Snap-on as well as screw mount faceplates, for mounting the power receptacle outside of the raceway channel. T-70 raceway will be manufactured from impact-resistant material with flammability rating of V-0. T-70 raceway must be tamper resistant yet, also allow access for moves, adds and changes. T-70 raceway finish shall be pure color and will resist scratches and dents and will not peel or corrode. T-70 raceway shall be available in four standard colors and shall be optimized for use with the Pan-Net Communication System.

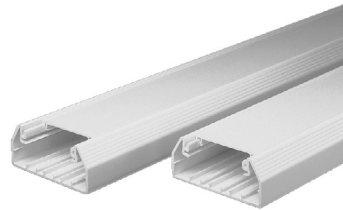

## technical information

<b>Material:</b>	Rigid PVC
<b>Flammability:</b>	UL94V-0; FT4
<b>Voltage rating:</b>	UL-5A 600VAC; CSA C22.2 No. 62.1-03 600 V
<b>Safety compliance:</b>	UL Listed 95425 (raceway); UL Listed E116129 (fittings)
<b>NEC:</b>	Article 388
<b>Color:</b>	Off White (IW), Electrical Ivory (EI), White (WH)
<b>CSI spec form:</b>	LP-CSISPEC-T70-1

## key features and benefits

<b>1" bend radius control fittings:</b>	Reduces time required for planning, designing, procurement, and installation, resulting in simpler specification and up to 75% faster implementation
<b>Snap-on faceplates:</b>	Faceplates snap directly onto the raceway base; cabling can be quickly accessed by removing only the faceplate, requiring less labor and cost of maintenance
<b>Channel has a 70mm opening:</b>	Accepts NEMA standard snap-on or screw-on power or communication faceplates from all manufacturers
<b>Highly tamper resistant:</b>	Very difficult for untrained personnel to enter the raceway or remove faceplates; provides maximum security for communication cabling and maximum safety for power cabling
<b>Non-metallic construction:</b>	Lightweight reduces installer fatigue; solid color throughout profile will not chip peel, rust, corrode, or scratch; easy to cut reducing the need for special cutting devices; high impact resistance; durable
<b>Designer profile:</b>	Aesthetically pleasing and matches a wide variety of decors
<b>Available in three standard colors:</b>	Matches a variety of colors for various applications

## applications

Pan-Way T-70 Non-Metallic Surface Raceway is a multi-channel channel raceway which provides solutions for routing low voltage, fiber optic and/or power cabling along perimeter walls. T-70 raceway can mount NEMA standard screw-on faceplates or superior Pan-Way Snap-on Faceplates directly to the channel. T-70 features the Workstation Outlet Center™ Offset Box, which provides an offset solution to maximize channel capacity and outlet density.

### Pan-Way T-70 Raceway

<b>Raceway Base</b>	
<b>6 feet:</b>	T70BIW6
<b>8 feet:</b>	T70BIW8
<b>10 feet:</b>	T70BIW10
<b>Raceway Cover</b>	
<b>6 feet:</b>	T70CIW6
<b>8 feet:</b>	T70CIW8
<b>10 feet:</b>	T70CIW10
<b>Divider Wall</b>	
<b>6 feet:</b>	T70DW6
<b>8 feet:</b>	T70DW8
<b>10 feet:</b>	T70DW10

### T-70 Raceway Fittings and Accessories

<b>Base coupling:</b>	T70BCIW-X
<b>Cover coupling:</b>	T70CCIW-X
<b>Outside corner fitting:</b>	T70OCIW
<b>Inside corner fitting:</b>	T70ICIW
<b>Right angle fitting:</b>	T70RAIW
<b>End cap fitting:</b>	T70ECIW
<b>Entrance end fitting:</b>	T70EEIW
<b>Tee fitting:</b>	T70TIW
<b>Insert for tee fitting:</b>	T70TD
<b>Transition fitting base/cover:</b>	T70TRIW
<b>Transition fitting cover only:</b>	T70TRCIW
<b>Wire retainer:</b>	T70WR-X
<b>Device bracket:</b>	T70DB-X
<b>Standard faceplate bracket:</b>	T70SDB-X
<b>Three-sided hanging box:</b>	T70HB3-X
<b>Hanging box:</b>	T70HB-X
<b>Workstation Outlet Center Offset Box:</b>	T70WCIW
<b>Workstation Outlet Center Offset Box:</b>	T70WC2IW

For standard colors other than IW (Off White), replace IW in part number with EI (Electrical Ivory), or WH (White).

# Pan-Way® T-70 Surface Raceway System

## wire fill

Raceway Type and Configuration	Fill Area (in <sup>2</sup> )	Electrical Cables			Data Grade Cables								Coax Cables				Fiber Optic Cable	
		14 AWG	12 AWG	10 AWG	24 AWG		23 AWG		26 AWG		23 AWG		RG6		RG59/u		2 Strand	
		THHN/THWN/T90	THHN/THWN/T90	THHN/THWN/T90	Cat. 5e		Cat. 6		Cat. 6A (SD)		Cat. 6A		DIA = 0.275		DIA = 0.242		DIA = 0.175	
		0.111	0.130	0.164	DIA = 0.193		DIA = 0.240		DIA = 0.240		DIA = 0.300		DIA = 0.275		DIA = 0.242		DIA = 0.175	
		FILL			FILL		FILL		FILL		FILL		FILL		FILL		FILL	
		MAX	MAX	MAX	SPEC	MAX	SPEC	MAX	SPEC	MAX	SPEC	MAX	SPEC	MAX	SPEC	MAX	SPEC	MAX
(UL Temp Rise Test)			(40%)	(60%)	(40%)	(60%)	(40%)	(60%)	(40%)	(60%)	(40%)	(60%)	(40%)	(60%)	(40%)	(60%)	(40%)	(60%)
T-70: No Devices	5.15	24	20	15	70	105	45	68	45	68	29	43	34	52	44	67	85	128
T-70: Power and data using the three-sided hanging box and device bracket	0.86	14	11	7	-	-	-	-	-	-	-	-	-	-	-	-	-	-
	1.72	-	-	-	23	35	15	22	15	22	9	14	11	17	14	22	28	42
T-70: Data only (Screw-on Faceplates)	3.67	-	-	-	50	75	32	48	32	48	20	31	24	37	31	47	61	91
T-70: Data only (Snap-on Faceplates)	4.71	-	-	-	64	96	41	62	41	62	26	39	31	47	40	61	78	117
T-70: Power and data using the Workstation Outlet Center™ Offset Box	0.91	14	11	7	-	-	-	-	-	-	-	-	-	-	-	-	-	-
	3.12	-	-	-	42	63	27	41	27	41	17	26	21	31	27	40	51	77

Note: For all cable options please see the Raceway Cable Fill Calculator on [www.panduit.com/calculators](http://www.panduit.com/calculators).

## t-70 raceway

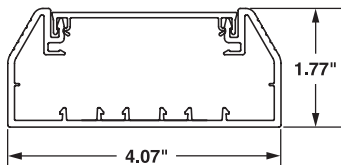

T-70  
Internal Area = 5.15 Sq. In.

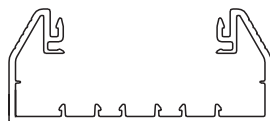

T70B



T70C

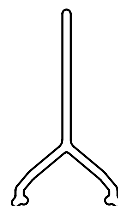

T70DW

# Pan-Way® T-70 Surface Raceway System

## fittings and accessories

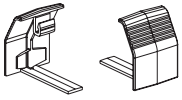

T70BC-X

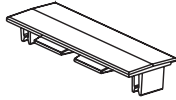

T70CC-X

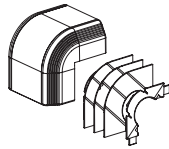

T700C

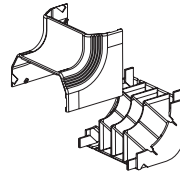

T70IC

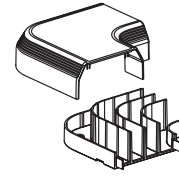

T70RA

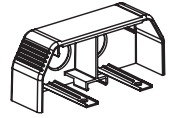

T70EC

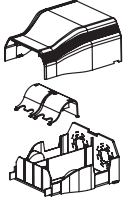

T70EE

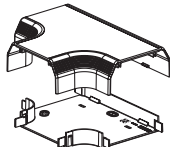

T70T

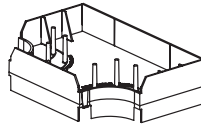

T70TD

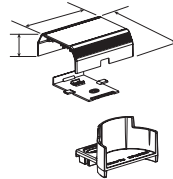

T70TR  
T70TRC

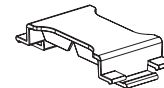

T70WR-X

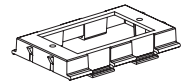

T70DB-X

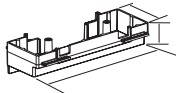

T70HB3-X

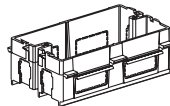

T70HB-X

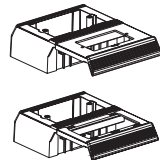

T70WC  
T70WC2

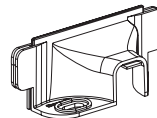

T70TRI



T70SDB-X

### WORLDWIDE SUBSIDIARIES AND SALES OFFICES

PANDUIT US/CANADA  
Phone: 800.777.3300

PANDUIT EUROPE LTD.  
London, UK  
Phone: 44.20.8601.7200

PANDUIT SINGAPORE PTE. LTD.  
Republic of Singapore  
Phone: 65.6305.7575

PANDUIT JAPAN  
Tokyo, Japan  
Phone: 81.3.6863.6000

PANDUIT LATIN AMERICA  
Guadalajara, Mexico  
Phone: 52.33.3777.6000

PANDUIT AUSTRALIA PTY. LTD.  
Victoria, Australia  
Phone: 61.3.9794.9020

For a copy of Panduit product warranties, log on to [www.panduit.com/warranty](http://www.panduit.com/warranty)

# PANDUIT®

For more information  
Visit us at [www.panduit.com](http://www.panduit.com)  
Contact Customer Service by email: [cs@panduit.com](mailto:cs@panduit.com)  
or by phone: 800.777.3300

© 2023 Panduit Corp.  
ALL RIGHTS RESERVED.  
FRSP34-WW-ENG  
3/2023