

Standard

STANDARD LPL59M

Available for many fluorescent lamp types sold today, including Preheat, Rapid Start, 2-pin CFL, Slimline, High Output, Very High Output and Circline. Magnetic ballasts can be used in any application where these lamps are used.

Product data

General Information		Rated Lamp Power	
Lamp Type	F8T5	8 W	
Number Of Lamps	1 piece/unit		
Lamp Footage	-	Wiring	
Ballast Type	Magnetic Fluorescent	Wire Striplength	0.50/0.375 mm
Base Model	LPL59	Lamp Connection	Series
Suitable For Outdoor Use	Yes	Wire Length By Color	See data sheet
Automatic Restart	Yes	Wire Gauge (Nom)	18AWG mm
		Wire Type	Solid
Operating and Electrical		Remote Wiring Configuration Allowed	Yes
Input Voltage	120 V	Tandem Wiring Configuration Allowed	No
Input Frequency	60 Hz	Through Wiring Configuration Allowed	No
Total Harmonic Distortion USA	10 %	Max Ballast-Lamp Distance Remote Wiring	30'
Ignition Method	Preheat	Max Ballast-Lamp Distance Tandem Wiring	-
Crestfactor (Nom)	1.5	Max Ballast-Lamp Distance Through Wiring	-
Ignition Time (Nom)	1 s	Mechanical and Housing	
Input Current (Open Circuit)	0	Housing Material	Metal
Input Current (Starting)	0.19	Housing	X1
Ballast Factor (Nom)	1	Housing Dimensions	2.38" x 1.38" x 1.38"
Power Factor (Nom)	0.53	Approval and Application	
Input Current (Nom)	0.14 A	EMC Immunity Standard	FCC Non-Consumer
Input Power (Nom)	9 W	Approval Marks	CSA certificate UL certificate RoHS Compliant

Standard

Hum And Noise Level	A
UL Recognized	No

Product Data

Order product name	STANDARD LPL59M
EAN/UPC - Product	781087003718
Order code	913700509609

Numerator - Quantity Per Pack	1
Numerator - Packs per outer box	135
Material Nr. (12NC)	913700509609
Net Weight (Piece)	0.123 kg

Dimensional drawing

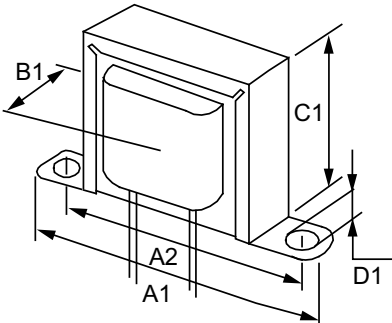

MAG BALLAST (1) F8T5 PH 120V

Product	A1	A2	B1	C1	D1
---------	----	----	----	----	----

