

# Core & Coil (71A) MH ~LT~ 175W

## CORE & COIL HID 71A5390001D

The basic ballast is the open core and coil which is most often used as a component within a lighting luminaire. The core and coil also forms the nucleus of Philips Advance's five other ballast configurations.

### Product data

General Information		Operating and Electrical	
ANSI Code	M90-M140	Input Voltage	120/208/240/277 V
Lamp Type	100 MH	Input Frequency	60 Hz
Number Of Lamps	1 piece/unit	Power (Rated) (Nom)	100 W
Circuit Type	HX-HPF	Input Current (Open Circuit)	2.5/1.5/1.3/1.12 A
Ballast Type	Magnetic HID	Input Current (Starting)	1.24/0.54/0.45/0.4 A
Base Model	71A5390	Input Current (Short Circuit)	0.63-0.95/0.43-0.65/0.37-0.55/0.29-0.44 A
Core Size	3 X 4 (2 LW)	Secondary Short Circuit Current	1.35-1.7 A
Suitable For Outdoor Use	Yes	Constant Wattage Deviation	12%
Ignitor Catalog Number	LI533-H4	Ballast Factor (Nom)	1
Ignitor Temperature Rating	105°C	Power Factor (Nom)	0.90
Capacitor Value	12 MFD	Open Circuit Voltage	260 V
Capacitor Catalog Number	7C120M30RA	Input Current (Nom)	1.15/0.66/0.58/0.5 A A
Capacitor Requirements	280V	Input Power (Nom)	129 W
Capacitor Temperature Rating	105°C	Rated Lamp Power	100W W
Capacitor Diameter/Oval Dimensions	1.65 in	Wiring	
Capacitor Height	2.75 in	Wire Striplength	0.5 mm
Automatic Restart	No	Wire Length By Color	12"
		Wire Type	Stranded

Core & Coil (71A) MH ~LT~ 175W

Remote Wiring Configuration Allowed	Yes
Max Ballast-Lamp Distance Remote Wiring	20'
Recommended Fuse Value	10/5/5/4 A
Approval and Application	
Open Circuit Voltage Test (Volts)	240-300 V
Approval Marks	ULR CSA certificate RoHS Compliant
Temperature Marking	B/B/A/A
UL Recognized	Yes
Hipot Test (1 Minute)	2000 V
Hipot Test (2 Seconds)	2500 V
UL Insulation Class	H(180°C)

UL Temperature Code	1029B
Product Data	
Order product name	CORE & COIL HID 71A5390001D
EAN/UPC - Product	781087017838
Order code	913700533009
Numerator - Quantity Per Pack	1
Numerator - Packs per outer box	1
Material Nr. (12NC)	913700533009
Net Weight (Piece)	2.541 kg

Dimensional drawing

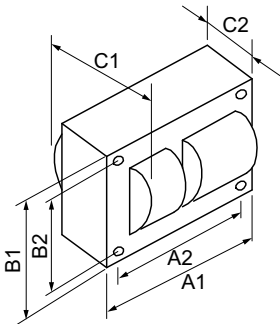

Product	C1	C2	A1	A2	B1	B2
---------	----	----	----	----	----	----

MH BAL 100W 90/140 QUAD KIT

