

# Xitanium LED Driver Outdoor Fixed (US)

## Xitanium 20W 0.7A 28V 120V OUTDOOR

Xitanium Outdoor LED Drivers are available in wattages from 40W to 150W for hard-wire integration into outdoor luminaires for the most rugged applications. These drivers operate to specification under wide temperature and electrical ranges to ensure reliability.

### Product data

<b>Operating and Electrical</b>		<b>Output Wire Gauge</b>	
Input Frequency	60 Hz	18	
Total Harmonic Distortion IEC (Max)	20 %	<b>Temperature</b>	
Output Current Ripple (Nom)	10 %	T-Ambient (Max)	
Maximum Efficiency	85 %	60 °C	
Power Factor 100% Load (Min)	0.9	T-Ambient (Min)	
Output Current (Nom)	700 mA	-40 °C	
Output Current Tolerance (Max)	10 %	T-Case Maximum (Max)	
Output Current Tolerance (Min)	-10 %	90 °C	
Input Voltage (AC)	120 V	<b>Approval and Application</b>	
Input Current (Max)	200 mA	Short Circuit Protection	
Input Power (Nom)	24 W	Protected	
Output Power (Nom)	20 W	EMI Standard	
Output Voltage	2.8-28 V	FCC 47 Subpart 18; Class A	
<b>Wiring</b>		Environmental Standard	
Connector Type Input Terminals	Wago 250	UL Damp & Dry	
Output Wire Length	152.4 mm	Approval Marks	
Input Wire Gauge	18	RoHS compliance UL certificate CSA certificate	
		Output Insulation	
		Yes	
		<b>Product Data</b>	
		Full product code	
		871016319631200	
		Order product name	
		Xitanium 20W 0.7A 28V 120V OUTDOOR	
		EAN/UPC - Product	
		781087072042	
		Order code	
		913710847102	
		Numerator - Quantity Per Pack	
		1	

Xitanium LED Driver Outdoor Fixed (US)

Numerator - Packs per outer box	10
Material Nr. (12NC)	913710847102
Net Weight (Piece)	0.123 kg

Dimensional drawing

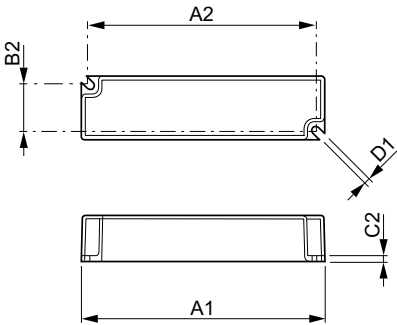

20W/0.7A 120V 60Hz OUTDOOR ROHS

Product	D1	B2	C1	C2	A1	A2	B1
---------	----	----	----	----	----	----	----

